

Geberit installation set for WC flush controls with electronic flush actuation, 4.1 V

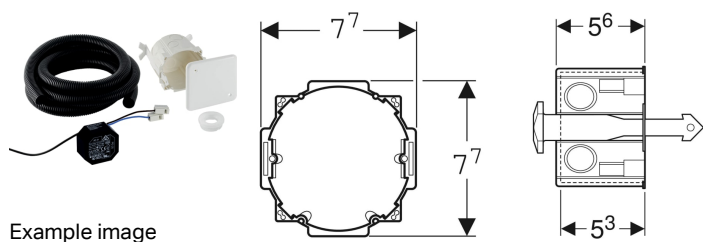

Example image

Application purposes

- For solid and drywall construction
- For concealed installation
- For preparing the mains connections of Geberit WC flush controls Sigma10 and Sigma80
- For connecting cables between concealed outlets and concealed cisterns

Characteristics

- Transformation of mains voltage to extra-low voltage, 4.1 V DC

Scope of delivery

- Cover for flush-mounting box
- Concealed outlet for drilling hole \varnothing 76 mm
- Pipe entry
- Power supply unit
- Conduit pipe, length 1.7 m

Technical data

Protection degree	IP20
Nominal voltage	85-240 V AC
Mains frequency	50-60 Hz
Output voltage	4.1 V DC
Power	5 W

Art. no.

115.861.00.1